

INSTRUCTIONS ON HOW TO LOAD A GREASE GUN AND ATTACH IT TO A GREASE NIPPLE

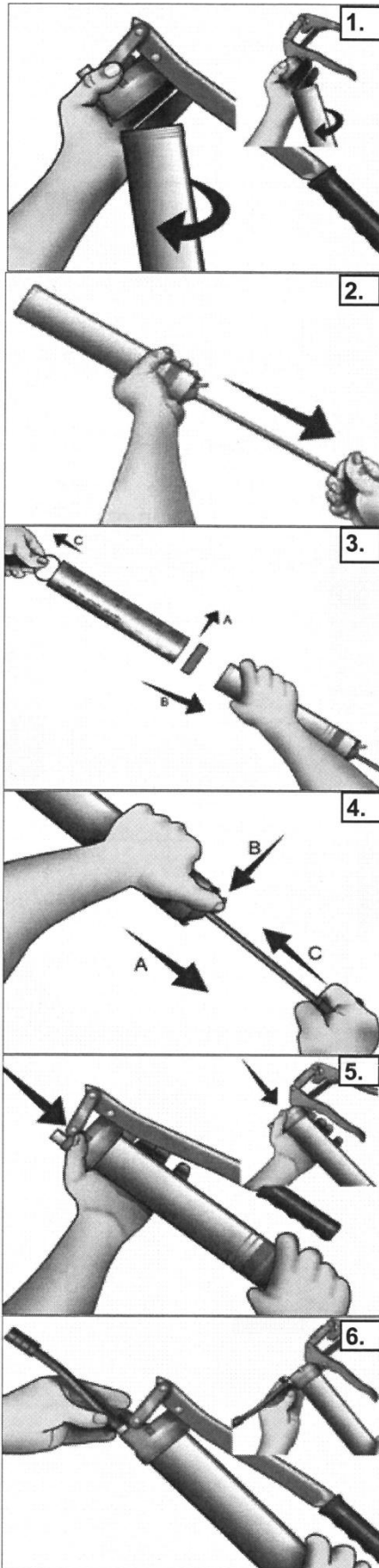

Instructions for loading the grease gun with grease cartridges

1. To change a grease cartridge grip the gun by its head and unscrew the barrel anti-clockwise.
2. Draw back the pull rod to the end of the barrel where it should lock onto the ratchet clip.
3. A - remove cap from the grease cartridge.
B - insert cartridge into the barrel open end first.
C - remove ring-pull from the other end of the cartridge.
4. Re-attach head of gun to the barrel.
A - pull back pull rod slightly to release ratchet clip
B - release ratchet lever
C - push back the pull rod into the gun barrel
5. Press the ventilation valve in the head of the gun to bleed air out of the head.
6. Assemble accessories (hose or nozzle tube) and pump lever handle to dispense grease.

Instructions for attaching the 4-jaw connector to the grease nipple

1. Clean the grease nipple to avoid contamination getting into the grease.
2. Press the 4-jaw connector FIRMLY onto the grease nipple where it should attach with a positive 'clunk'.
3. Pump the lever handle to dispense grease through the nipple.
4. Twist the grease gun sideways at an angle to detach the 4-jaw connector from the nipple (approx 45°).
5. Clean any surplus grease from the nipple and connector.

